



CNC 複合式刀具

CNC COMPOSITE CUTTING TOOLS



宏泰工業股份有限公司

HORNG TAIR INDUSTRIAL CORP.

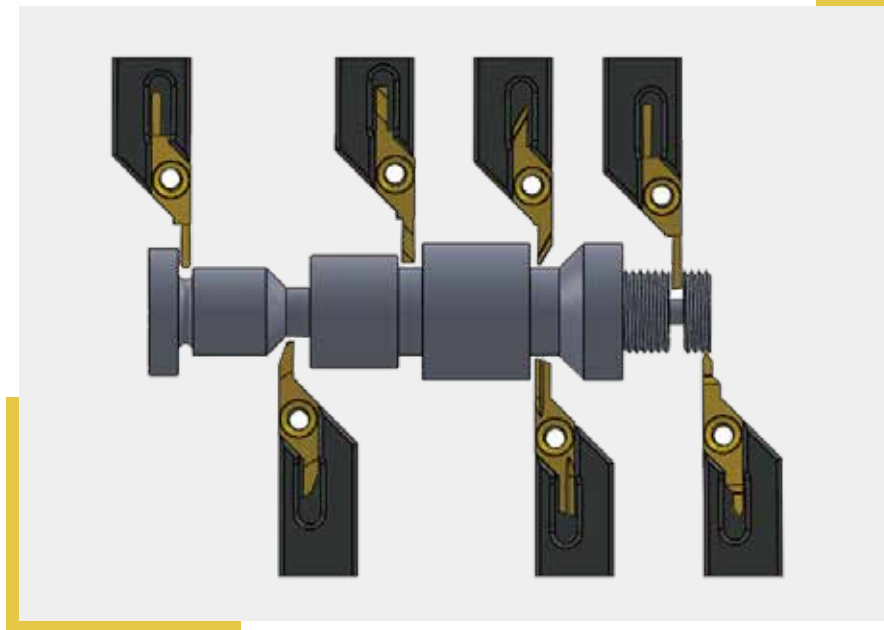

服務項目



CNC走心自動車床刀具銷售



可設計製作&附圖訂製生產



各類刀片整修&尺寸修改

產品特色



捨去式刀座, 拆裝省時、定位方便

A blade and a base can be separated, easy to assemble, easy to locate.



刀座可替換各種刀片, 增加調度靈活性

A base fits a wide range of blades.



非成熟技術員, 亦可輕鬆換裝刀片

It is easy to change a blade, even for unskilled operators.



可因應廠商需求, 訂製特殊刀片

Special blades can be provided according to the customer's request.

標準正向刀架

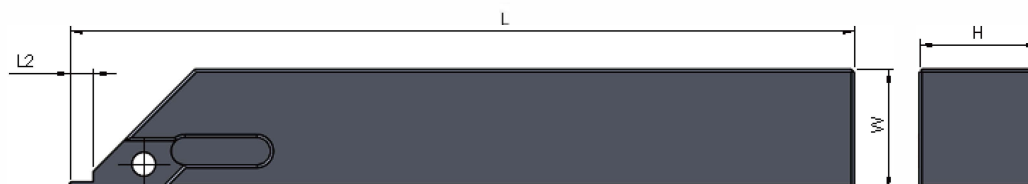



右向圖示(單位:mm)

品名 Item	型號 Item No.	W	H	L	L2	適用刀片Applicable Inserts	
						刃長Length	寬度Width
右向刀架 Right Direction Blade Base	A/R 0808-132	8	8	132	1.8	≤5	≤1.0
	A/R 1010-132	10	10	132			
	A/R 1212-132	12	12	132			
	A/R 1616-132	16	16	132			
	A/R 2020-132	20	20	132			
	A/R 2525-132	25	25	132			
左向刀架 Left Direction Blade Base	A/L 0808-132	8	8	132	1.8	≤5	≤1.0
	A/L 1010-132	10	10	132			
	A/L 1212-132	12	12	132			
	A/L 1616-132	16	16	132			
	A/L 2020-132	20	20	132			
	A/L 2525-132	25	25	132			
右向刀架 Right Direction Blade Base	A/R 0808-136	8	8	132	4	≥7	≥1.5
	A/R 1010-136	10	10	132			
	A/R 1212-136	12	12	132			
	A/R 1616-136	16	16	132			
	A/R 2020-136	20	20	132			
	A/R 2525-136	25	25	132			
左向刀架 Left Direction Blade Base	A/L 0808-136	8	8	132	4	≥7	≥1.5
	A/L 1010-136	10	10	132			
	A/L 1212-136	12	12	132			
	A/L 1616-136	16	16	132			
	A/L 2020-136	20	20	132			
	A/L 2525-136	25	25	132			

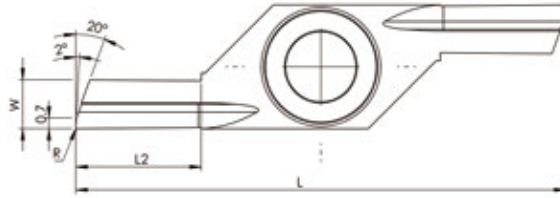
鋼材專用(2*) : 表面不披覆 ; 鋼材專用(1*) : 表面TiN披覆 ; 不鏽鋼材專用(J020) : 表面TiAlxN披覆



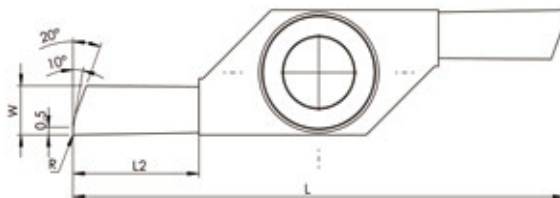

右向圖示(單位:mm)

	型號 Item No.	W	L	L2	R	塗層Plating		適用刀架(A/LR 0808~2525)	
						Tin	AiTLxN	132	136
 右 向 前 掃 刀 Turning Blade	ACS/R 3.0-8-2*	3.0	32	8					●
	ACS/R 3.0-8-1*	3.0	32	8		●			●
	ACS/R 3.0-8-J020	3.0	32	8	0.1		●		●
 左 向 前 掃 刀 Turning Blade	ACS/L 3.0-8-2*	3.0	32	8					●
	ACS/L 3.0-8-1*	3.0	32	8		●			●
	ACS/L 3.0-8-J020	3.0	32	8	0.1		●		●



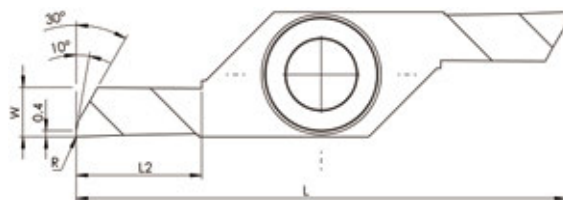

右向圖示(單位:mm)

	型號 Item No.	W	L	L2	R	塗層Plating		適用刀架(A/LR 0808~2525)	
						Tin	AiTLxN	132	136
 右 向 前 掃 刀 Turning Blade	ABS/R 3.0-8-2*	3.0	32	8					●
	ABS/R 3.0-8-1*	3.0	32	8		●			●
	ABS/R 3.0-8-J020	3.0	32	8	0.1		●		●
 左 向 前 掃 刀 Turning Blade	ABS/L 3.0-8-2*	3.0	32	8					●
	ABS/L 3.0-8-1*	3.0	32	8		●			●
	ABS/L 3.0-8-J020	3.0	32	8	0.1		●		●



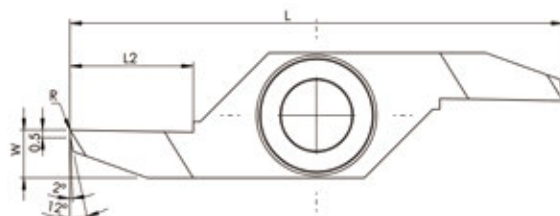

右向圖示(單位:mm)

型號 Item No.	W	L	L2	R	塗層Plating		適用刀架(A/LR 0808~2525)	
					Tin	AiTLxN	132	136
 右 向 前 掃 刀 Right Direction Front Turning Blade	AKS/R 3.0-8-2*	3.0	32	8				●
	AKS/R 3.0-8-1*	3.0	32	8		●		●
	AKS/R 3.0-8-J020	3.0	32	8	0.1		●	●
 左 向 前 掃 刀 Left Direction Front Turning Blade	AKS/L 3.0-8-2*	3.0	32	8				●
	AKS/L 3.0-8-1*	3.0	32	8		●		●
	AKS/L 3.0-8-J020	3.0	32	8	0.1		●	●



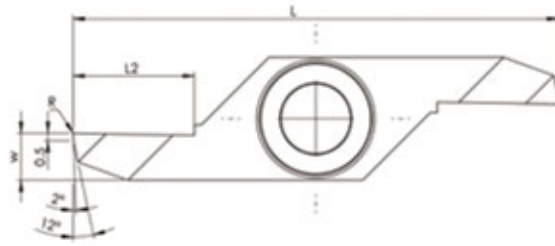

右向圖示(單位:mm)

型號 Item No.	W	L	L2	R	塗層Plating		適用刀架(A/LR 0808~2525)	
					Tin	AiTLxN	132	136
 右 向 後 掃 刀 Right Direction Back Turning Blade	AFS/R 3.0-8-2*	3.0	32	8				●
	AFS/R 3.0-8-1*	3.0	32	8		●		●
	AFS/R 3.0-8-J020	3.0	32	8	0.1		●	●
 左 向 後 掃 刀 Left Direction Back Turning Blade	AFS/L 3.0-8-2*	3.0	32	8				●
	AFS/L 3.0-8-1*	3.0	32	8		●		●
	AFS/L 3.0-8-J020	3.0	32	8	0.1		●	●



右向圖示(單位:mm)

型號 Item No.	W	L	L2	R	塗層Plating		適用刀架(A/LR 0808~2525)	
					Tin	AiTLxN	132	136
 右向後掃刀 Right Direction Back Turning Blade	AES/R 3.0-8-2*	3.0	32	8				●
	AES/R 3.0-8-1*	3.0	32	8		●		●
	AES/R 3.0-8-J020	3.0	32	8	0.1		●	●
 左向後掃刀 Left Direction Back Turning Blade	AES/L 3.0-8-2*	3.0	32	8				●
	AES/L 3.0-8-1*	3.0	32	8		●		●
	AES/L 3.0-8-J020	3.0	32	8	0.1		●	●

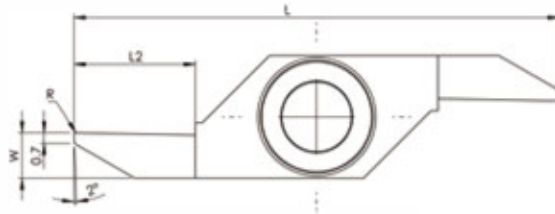

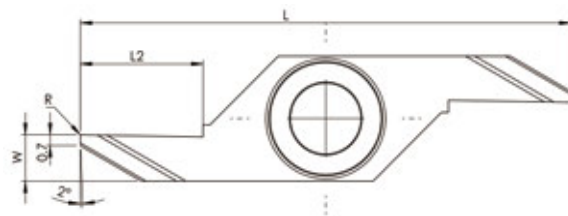

右向圖示(單位:mm)

型號 Item No.	W	L	L2	R	塗層Plating		適用刀架(A/LR 0808~2525)	
					Tin	AiTLxN	132	136
 右向後掃刀 Right Direction Back Turning Blade	AGS/R 3.0-8-2*	3.0	32	8				●
	AGS/R 3.0-8-1*	3.0	32	8		●		●
	AGS/R 3.0-8-J020	3.0	32	8	0.1		●	●
 左向後掃刀 Left Direction Back Turning Blade	AGS/L 3.0-8-2*	3.0	32	8				●
	AGS/L 3.0-8-1*	3.0	32	8		●		●
	AGS/L 3.0-8-J020	3.0	32	8	0.1		●	●





右向圖示(單位:mm)

	型號 Item No.	W	L	L2	R	塗層Plating		適用刀架(A/LR 0808~2525)	
						Tin	AiTLxN	132	136
 右向後掃刀 Right Direction Back Turning Blade	ADS/R 3.0-8-2*	3.0	32	8					●
	ADS/R 3.0-8-1*	3.0	32	8		●			●
	ADS/R 3.0-8-1*(R0.2)	3.0	32	8	0.2				●
	ADS/R 3.0-8-J020	3.0	32	8	0.1		●		●
 左向後掃刀 Left Direction Back Turning Blade	ADS/L 3.0-8-2*	3.0	32	8					●
	ADS/L 3.0-8-1*	3.0	32	8		●			●
	ADS/L 3.0-8-J020	3.0	32	8	0.1		●		●

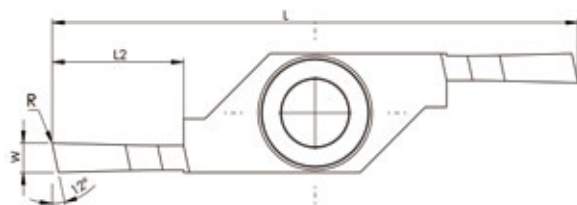
鋁用特製溝槽



右向圖示(單位:mm)

	型號 Item No.	W	L	L2	R	塗層Plating		適用刀架(A/LR 0808~2525)	
						Tin	AiTLxN	132	136
 右向切斷刀 Right Direction Parting-off Blade	AH/R 125-1.0-7-2*	1.0	32	7				●	
	AH/R 125-1.5-7-2*	1.5	32	7					●
	AH/R 125-1.5-9-2*	1.5	36	9					●
	AH/R 125-1.5-11-2*	1.5	38	11					●
	AH/R 125-2.0-9-2*	2.0	36	9					●
	AH/R 125-2.0-11-2*	2.0	38	11					●
	AH/R 125-2.5-9-2*	2.5	36	9					●
	AH/R 125-2.5-11-2*	2.5	38	11					●
	AH/R 125-3.0-9-2*	3.0	36	9					●
AH/R 125-3.0-11-2*	3.0	38	11					●	
 左向切斷刀 Left Direction Parting-off Blade	AH/L 125-1.0-7-2*	1.0	32	7				●	
	AH/L 125-1.5-7-2*	1.5	32	7					●
	AH/L 125-1.5-9-2*	1.5	36	9					●
	AH/L 125-2.0-9-2*	2.0	36	9					●
	AH/L 125-2.5-9-2*	2.5	36	9					●
	AH/L 125-2.5-11-2*	2.5	38	11					●
AH/L 125-3.0-9-2*	3.0	36	9					●	

鋁用特製溝槽

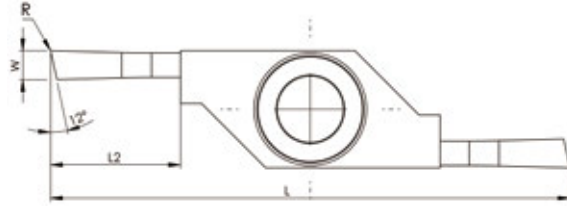



左向圖示(單位:mm)

型號 Item No.	W	L	L2	R	塗層Plating		適用刀架(A/LR 0808~2525)	
					Tin	AiTLxN	132	136
 左向 Right Side Parting-off Blade 斷刀	AH/L 125-1.0-7-2* 反向	1.0	32	7			●	
	AH/L 125-1.5-7-2* 反向	1.5	32	7				●
	AH/L 125-1.5-9-2* 反向	1.5	36	9				●
	AH/L 125-2.0-9-2* 反向	2.0	36	9				●
	AH/L 125-2.0-11-2* 反向	2.0	38	11				●
	AH/L 125-2.5-9-2* 反向	2.5	36	9				●

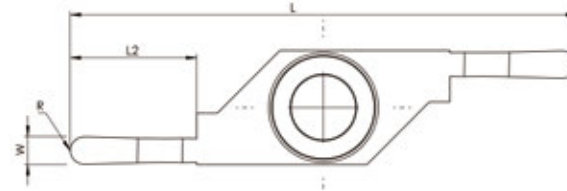
鋁用特製溝槽





右向圖示(單位:mm)

型號 Item No.	W	L	L2	R	塗層Plating		適用刀架(A/LR 0808~2525)	
					Tin	AiTLxN	132	136
 右向 Round Nose Blade	ARS/R 1.0-5-2* 鋁溝	1.0	28	5	0.50		●	
	ARS/R 1.0-7-2* 鋁溝	1.0	32	7	0.50		●	
	ARS/R 1.5-5-2* 鋁溝	1.5	28	5	0.75		●	
	ARS/R 1.5-9-2* 鋁溝	1.5	36	9	0.75			●
	ARS/R 2.0-5-2* 鋁溝	2.0	28	5	1.00		●	
	ARS/R 2.0-9-2* 鋁溝	2.0	36	9	1.00			●
	ARS/R 2.5-5-2* 鋁溝	2.5	28	5	1.25		●	
	ARS/R 2.5-9-2* 鋁溝	2.5	36	9	1.25			●
	ARS/R 3.0-5-2* 鋁溝	3.0	28	5	1.50		●	
	ARS/R 3.0-9-2* 鋁溝	3.0	36	9	1.50			●
 左向 Round Nose Blade	ARS/L 1.0-5-2* 鋁溝	1.0	28	5	0.50		●	
	ARS/L 1.5-5-2* 鋁溝	1.5	28	5	0.75		●	
	ARS/L 1.5-9-2* 鋁溝	1.5	36	9	0.75			●
	ARS/L 2.0-5-2* 鋁溝	2.0	28	5	1.00		●	
	ARS/L 2.0-9-2* 鋁溝	2.0	36	9	1.00			●
	ARS/L 2.5-5-2* 鋁溝	2.5	28	5	1.25		●	
	ARS/L 2.5-9-2* 鋁溝	2.5	36	9	1.25			●

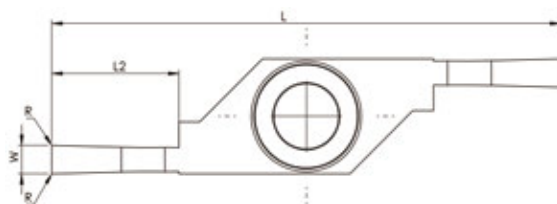
鋁用特製溝槽



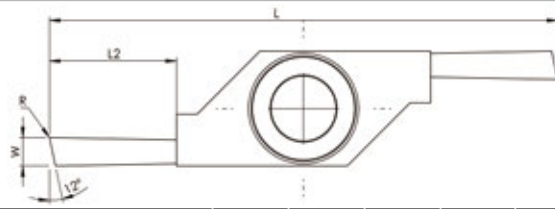

右向圖示(單位:mm)

型號 Item No.	W	L	L2	R	塗層Plating		適用刀架(A/LR 0808~2525)		
					Tin	AiTlXN	132	136	
 Right Direction Grooving Blade	AP/R 00-0.5-5-2* 鋁溝(R0.1)	0.5	28	5	0.1			●	
	AP/R 00-1.0-5-2* 鋁溝(R0.1)	1.0	28	5	0.1			●	
	AP/R 00-1.5-5-2* 鋁溝(R0.1)	1.5	28	5	0.1			●	
	AP/R 00-1.5-9-2* 鋁溝(R0.1)	1.5	36	9	0.1				●
	AP/R 00-2.0-5-2* 鋁溝(R0.1)	2.0	28	5	0.1			●	
	AP/R 00-2.0-9-2* 鋁溝(R0.1)	2.0	36	9	0.1				●
	AP/R 00-2.5-5-2* 鋁溝(R0.1)	2.5	28	5	0.1			●	
	AP/R 00-2.5-9-2* 鋁溝(R0.1)	2.5	36	9	0.1				●
	AP/R 00-3.0-5-2* 鋁溝(R0.1)	3.0	28	5	0.1			●	
	AP/R 00-3.0-9-2* 鋁溝(R0.1)	3.0	36	9	0.1				●
 Left Direction Grooving Blade	AP/L 00-0.5-5-2* 鋁溝(R0.1)	0.5	28	5	0.1			●	
	AP/L 00-1.0-5-2* 鋁溝(R0.1)	1.0	28	5	0.1			●	
	AP/L 00-1.5-5-2* 鋁溝(R0.1)	1.5	28	5	0.1			●	
	AP/L 00-1.5-9-2* 鋁溝(R0.1)	1.5	36	9	0.1				●
	AP/L 00-2.0-5-2* 鋁溝(R0.1)	2.0	28	5	0.1			●	
	AP/L 00-2.0-9-2* 鋁溝(R0.1)	2.0	36	9	0.1				●
	AP/L 00-2.5-5-2* 鋁溝(R0.1)	2.5	28	5	0.1			●	
	AP/L 00-2.5-9-2* 鋁溝(R0.1)	2.5	36	9	0.1				●
	AP/L 00-3.0-5-2* 鋁溝(R0.1)	3.0	28	5	0.1			●	
	AP/L 00-3.0-9-2* 鋁溝(R0.1)	3.0	36	9	0.1				●



右向圖示(單位:mm)

型號 Item No.	W	L	L2	R	塗層Plating		適用刀架(A/LR 0808~2525)		
					Tin	AiTLxN	132	136	
 右向切斷刀 Right Direction Parting-off Blade	AH/R 125-1.0-7-1*	1.0	32	7			●		
	AH/R 125-1.0-9-1*	1.0	36	9			●		
	AH/R 125-1.5-7-1*	1.5	32	7				●	
	AH/R 125-1.5-9-1*	1.5	36	9				●	
	AH/R 125-1.5-11-1*	1.5	38	11				●	
	AH/R 125-2.0-9-1*	2.0	36	9				●	
	AH/R 125-2.0-11-1*	2.0	38	11		●		●	
	AH/R 125-2.0-13-1*	2.0	38	13				●	
	AH/R 125-2.5-9-1*	2.5	36	9				●	
	AH/R 125-2.5-11-1*	2.5	38	11				●	
	AH/R 125-3.0-9-1*	3.0	36	9				●	
	AH/R 125-3.0-11-1*	3.0	38	11				●	
	AH/R 125-3.0-13-1*	3.0	38	13				●	
	AH/R 125-1.0-7-J020	1.0	32	7	0.1			●	
	AH/R 125-1.5-7-J020	1.5	32	7	0.1				●
	AH/R 125-1.5-9-J020	1.5	36	9	0.1		●		●
	AH/R 125-2.0-9-J020	2.0	36	9	0.1				●
	AH/R 125-2.5-9-J020	2.5	36	9	0.1				●
AH/R 125-3.0-9-J020	3.0	36	9	0.1				●	
 左向切斷刀 Left Direction Parting-off Blade	AH/L 125-1.0-7-1*	1.0	32	7			●		
	AH/L 125-1.5-7-1*	1.5	32	7				●	
	AH/L 125-1.5-9-1*	1.5	36	9				●	
	AH/L 125-2.0-9-1*	2.0	36	9		●		●	
	AH/L 125-2.0-11-1*	2.0	38	11				●	
	AH/L 125-2.5-9-1*	2.5	36	9				●	
	AH/L 125-3.0-9-1*	3.0	36	9				●	
	AH/L 125-1.0-7-J020	1.0	32	7	0.1			●	
	AH/L 125-1.5-7-J020	1.5	32	7	0.1		●		●
	AH/L 125-2.5-9-J020	2.5	36	9	0.1				●

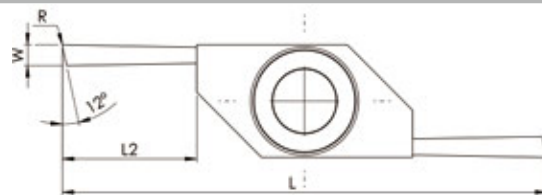

左向圖示(單位:mm)

型號 Item No.	W	L	L2	R	塗層Plating		適用刀架(A/LR 0808~2525)		
					Tin	AiTLxN	132	136	
 左向右切斷刀 Left Direction Right Side Parting-off Blade	AH/L 125-1.0-7-1* 反向	1.0	32	7			●		
	AH/L 125-1.0-9-1* 反向	1.0	36	9			●		
	AH/L 125-1.5-7-1* 反向	1.5	32	7				●	
	AH/L 125-1.5-9-1* 反向	1.5	36	9		●		●	
	AH/L 125-2.0-9-1* 反向	2.0	36	9				●	
	AH/L 125-2.0-11-1* 反向	2.0	38	11				●	
	AH/L 125-2.5-9-1* 反向	2.5	36	9				●	
	AH/L 125-3.0-9-1* 反向	3.0	36	9				●	
	AH/L 125-1.0-7-J020 反向	1.0	32	7	0.1			●	
	AH/L 125-1.5-7-J020 反向	1.5	32	7	0.1				●
	AH/L 125-2.0-11-J020 反向	2.0	38	11	0.1		●		●
	AH/L 125-2.5-9-J020 反向	2.5	36	9	0.1				●
	AH/L 125-3.0-9-J020 反向	3.0	36	9	0.1				●

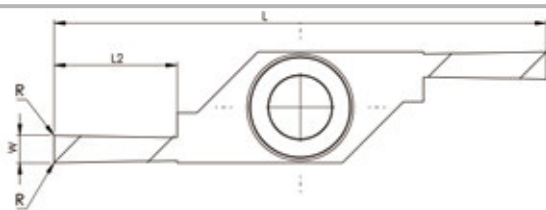

右向圖示(單位:mm)

型號 Item No.	W	L	L2	R	塗層Plating		適用刀架(A/LR 0808~2525)	
					Tin	AiTLxN	132	136
AH/R 00-0.5-5-2*	0.5	28	5				●	
AH/R 00-1.0-5-2*	1.0	28	5				●	
AH/R 00-1.0-5-2* (R0.2)	1.0	28	5	0.2			●	
AH/R 00-1.0-7-2*	1.0	32	7				●	
AH/R 00-1.5-5-2*	1.5	28	5				●	
AH/R 00-1.5-5-2* (R0.2)	1.5	28	5	0.2			●	
AH/R 00-1.5-9-2*	1.5	36	9					●
AH/R 00-1.5-9-2* (R0.2)	1.5	36	9	0.2				●
AH/R 00-2.0-5-2*	2.0	28	5				●	
AH/R 00-2.0-5-2* (R0.2)	2.0	28	5	0.2			●	
AH/R 00-2.0-9-2*	2.0	36	9					●
AH/R 00-2.0-9-2* (R0.2)	2.0	36	9	0.2				●
AH/R 00-2.5-5-2*	2.5	28	5				●	
AH/R 00-2.5-5-2* (R0.2)	2.5	28	5	0.2			●	
AH/R 00-2.5-9-2*	2.5	36	9					●
AH/R 00-2.5-9-2* (R0.2)	2.5	36	9	0.2				●
AH/R 00-3.0-5-2*	3.0	28	5				●	
AH/R 00-3.0-9-2*	3.0	36	9					●
AH/R 00-3.0-9-2* (R0.2)	3.0	36	9	0.2				●
AH/R 00-0.5-5-1*	0.5	28	5				●	
AH/R 00-1.0-5-1*	1.0	28	5				●	
AH/R 00-1.0-5-1* (R0.2)	1.0	28	5	0.2			●	
AH/R 00-1.0-7-1*	1.0	32	7				●	
AH/R 00-1.0-9-1*	1.0	36	9				●	
AH/R 00-1.5-5-1*	1.5	28	5				●	
AH/R 00-1.5-5-1* (R0.2)	1.5	28	5	0.2			●	
AH/R 00-1.5-9-1*	1.5	36	9					●
AH/R 00-1.5-9-1* (R0.2)	1.5	36	9	0.2				●
AH/R 00-2.0-5-1*	2.0	28	5				●	
AH/R 00-2.0-5-1* (R0.2)	2.0	28	5	0.2			●	
AH/R 00-2.0-7.5-1*	2.0	32	7.5					●
AH/R 00-2.0-7.5-1* (R0.2)	2.0	32	7.5	0.2	●			●
AH/R 00-2.0-9-1*	2.0	36	9					●
AH/R 00-2.0-9-1* (R0.2)	2.0	36	9	0.2				●
AH/R 00-2.0-11-1*	2.0	38	11					●
AH/R 00-2.5-5-1*	2.5	28	5				●	
AH/R 00-2.5-5-1* (R0.2)	2.5	28	5	0.2			●	
AH/R 00-2.5-7-1*	2.5	32	7					●
AH/R 00-2.5-9-1*	2.5	36	9					●
AH/R 00-2.5-9-1* (R0.2)	2.5	36	9	0.2				●
AH/R 00-3.0-5-1*	3.0	28	5				●	
AH/R 00-3.0-5-1* (R0.2)	3.0	28	5	0.2			●	
AH/R 00-3.0-9-1*	3.0	36	9					●
AH/R 00-3.0-9-1* (R0.2)	3.0	36	9	0.2				●
AH/R 00-0.5-5-J020	0.5	28	5	0.1			●	
AH/R 00-1.0-5-J020	1.0	28	5	0.1			●	
AH/R 00-1.5-5-J020	1.5	28	5	0.1			●	
AH/R 00-1.5-5-J020 (R0.2)	1.5	28	5	0.2			●	
AH/R 00-1.5-9-J020	1.5	36	9	0.1				●
AH/R 00-2.0-5-J020	2.0	28	5	0.1			●	
AH/R 00-2.0-5-J020 (R0.2)	2.0	28	5	0.2		●	●	
AH/R 00-2.0-7-J020	2.0	32	7	0.1				●
AH/R 00-2.0-9-J020	2.0	36	9	0.1				●
AH/R 00-2.5-5-J020	2.5	28	5	0.1			●	
AH/R 00-2.5-9-J020	2.5	36	9	0.1				●
AH/R 00-3.0-5-J020	3.0	28	5	0.1			●	
AH/R 00-3.0-9-J020	3.0	36	9	0.1				●



右向切槽刀
Right Direction Grooving Blade

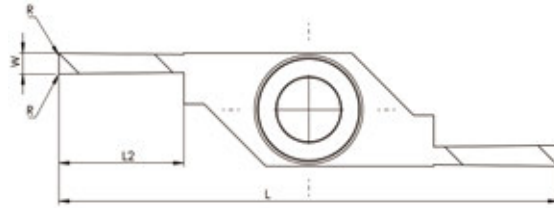

左向圖示(單位:mm)



型號 Item No.	W	L	L2	R	塗層Plating		適用刀架(A/LR 0808~2525)	
					Tin	AiTlXN	132	136
AH/L 00-0.5-5-2*	0.5	28	5				●	
AH/L 00-1.0-5-2*	1.0	28	5				●	
AH/L 00-1.5-5-2*	1.5	28	5				●	
AH/L 00-1.5-9-2*	1.5	36	9					●
AH/L 00-2.0-5-2*	2.0	28	5				●	
AH/L 00-2.0-9-2*	2.0	36	9					●
AH/L 00-2.5-5-2*	2.5	28	5				●	
AH/L 00-2.5-9-2*	2.5	36	9					●
AH/L 00-3.0-5-2*	3.0	28	5				●	
AH/L 00-3.0-9-2*	3.0	36	9					●
AH/L 00-0.5-5-1*	0.5	28	5				●	
AH/L 00-1.0-5-1*	1.0	28	5				●	
AH/L 00-1.5-5-1*	1.5	28	5				●	
AH/L 00-1.5-9-1*	1.5	36	9					●
AH/L 00-2.0-5-1*	2.0	28	5			●	●	
AH/L 00-2.0-9-1*	2.0	36	9					●
AH/L 00-2.5-5-1*	2.5	28	5				●	
AH/L 00-2.5-9-1*	2.5	36	9					●
AH/L 00-3.0-5-1*	3.0	28	5				●	
AH/L 00-3.0-9-1*	3.0	36	9					●
AH/L 00-0.5-5-J020	0.5	28	5	0.1			●	
AH/L 00-1.0-5-J020	1.0	28	5	0.1			●	
AH/L 00-1.5-5-J020	1.5	28	5	0.1			●	
AH/L 00-1.5-9-J020	1.5	36	9	0.1				●
AH/L 00-2.0-5-J020	2.0	28	5	0.1			●	
AH/L 00-2.0-9-J020	2.0	36	9	0.1				●
AH/L 00-2.5-5-J020	2.5	28	5	0.1			●	
AH/L 00-2.5-9-J020	2.5	36	9	0.1				●
AH/L 00-3.0-5-J020	3.0	28	5	0.1			●	
AH/L 00-3.0-9-J020	3.0	36	9	0.1				●

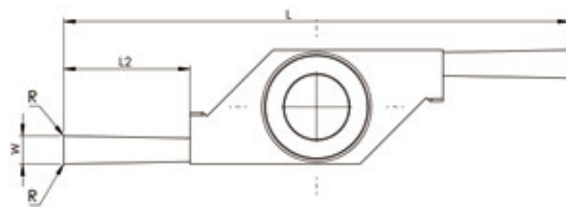

左向切槽刀
Left Direction Grooving Blade



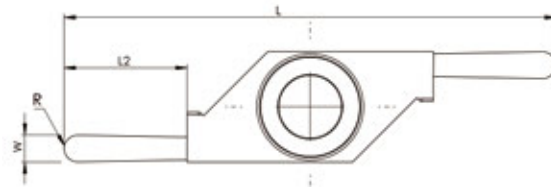

右向圖示(單位:mm)

型號 Item No.	W	L	L2	R	塗層Plating		適用刀架(A/LR 0808~2525)	
					Tin	AiTLxN	132	136
 右向切槽刀 Right Direction Grooving Blade	AP/R 00-0.5-3.5-1*	0.5	28	3.5			●	
	AP/R 00-0.5-3.5-1* (R0.2)	0.5	28	3.5	0.2		●	
	AP/R 00-0.5-5-1*	0.5	28	5			●	
	AP/R 00-0.5-5-1* (R0.2)	0.5	28	5	0.2		●	
	AP/R 00-1.0-5-1*	1.0	28	5			●	
	AP/R 00-1.0-5-1* (R0.2)	1.0	28	5	0.2		●	
	AP/R 00-1.0-7-1*	1.0	32	7			●	
	AP/R 00-1.0-7-1* (R0.2)	1.0	32	7	0.2		●	
	AP/R 00-1.0-9-1*	1.0	36	9			●	
	AP/R 00-1.5-5-1*	1.5	28	5			●	
	AP/R 00-1.5-5-1* (R0.2)	1.5	28	5	0.2		●	
	AP/R 00-1.5-7-1* (R0.2)	1.5	32	7	0.2			●
	AP/R 00-1.5-9-1*	1.5	36	9		●		●
	AP/R 00-1.5-9-1* (R0.2)	1.5	36	9	0.2	●		●
	AP/R 00-2.0-5-1*	2.0	28	5			●	
	AP/R 00-2.0-5-1* (R0.2)	2.0	28	5	0.2		●	
	AP/R 00-2.0-7.5-1* (R0.2)	2.0	32	7.5	0.2			●
	AP/R 00-2.0-9-1*	2.0	36	9				●
	AP/R 00-2.0-9-1* (R0.2)	2.0	36	9	0.2			●
	AP/R 00-2.5-5-1*	2.5	28	5			●	
	AP/R 00-2.5-5-1* (R0.2)	2.5	28	5	0.2		●	
	AP/R 00-2.5-9-1*	2.5	36	9				●
	AP/R 00-2.5-9-1* (R0.2)	2.5	36	9	0.2			●
	AP/R 00-3.0-5-1*	3.0	28	5			●	
AP/R 00-3.0-5-1* (R0.2)	3.0	28	5	0.2		●		
AP/R 00-3.0-9-1*	3.0	36	9				●	
AP/R 00-3.0-9-1* (R0.2)	3.0	36	9	0.2			●	
 左向切槽刀 Left Direction Grooving Blade	AP/L 00-0.5-3.5-1*	0.5	28	3.5			●	
	AP/L 00-0.5-5-1*	0.5	28	5			●	
	AP/L 00-1.0-5-1*	1.0	28	5			●	
	AP/L 00-1.0-5-1* (R0.2)	1.0	28	5	0.2		●	
	AP/L 00-1.5-5-1*	1.5	28	5			●	
	AP/L 00-1.5-7-1*	1.5	32	7				●
	AP/L 00-1.5-9-1*	1.5	36	9		●		●
	AP/L 00-2.0-5-1*	2.0	28	5			●	
	AP/L 00-2.0-5-1* (R0.2)	2.0	28	5	0.2		●	
	AP/L 00-2.0-7.5-1* (R0.2)	2.0	32	7.5	0.2			●
	AP/L 00-2.0-9-1*	2.0	36	9				●
	AP/L 00-2.5-5-1*	2.5	28	5			●	
	AP/L 00-2.5-9-1*	2.5	36	9				●
	AP/L 00-3.0-5-1*	3.0	28	5			●	
	AP/L 00-3.0-9-1*	3.0	36	9				●



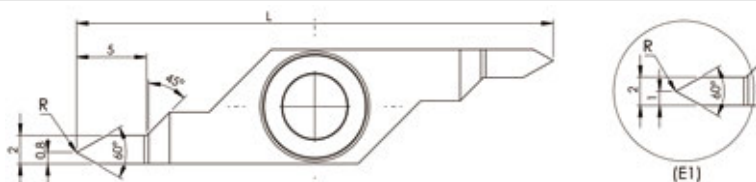

右向圖示(單位:mm)

型號 Item No.	W	L	L2	R	塗層Plating		適用刀架(A/LR 0808~2525)		
					Tin	AiTLxN	132	136	
 右向圓鼻刀 Right Direction Round Blade	ARS/R 1.0-5-2*	1.0	28	5	0.50			●	
	ARS/R 1.0-7-2*	1.0	32	7	0.50			●	
	ARS/R 1.5-5-2*	1.5	28	5	0.75			●	
	ARS/R 1.5-9-2*	1.5	36	9	0.75				●
	ARS/R 2.0-5-2*	2.0	28	5	1.00			●	
	ARS/R 2.0-9-2*	2.0	36	9	1.00				●
	ARS/R 2.5-5-2*	2.5	28	5	1.25			●	
	ARS/R 2.5-9-2*	2.5	36	9	1.25				●
	ARS/R 3.0-5-2*	3.0	28	5	1.50			●	
	ARS/R 3.0-9-2*	3.0	36	9	1.50				●
	ARS/R 0.5-3.5-1*	0.5	28	3.5	0.25			●	
	ARS/R 0.5-5-1*	0.5	28	5	0.25			●	
	ARS/R 1.0-5-1*	1.0	28	5	0.50	●		●	
	ARS/R 1.0-7-1*	1.0	32	7	0.50			●	
	ARS/R 1.5-5-1*	1.5	28	5	0.75			●	
	ARS/R 1.5-9-1*	1.5	36	9	0.75				●
	ARS/R 2.0-5-1*	2.0	28	5	1.00			●	
	ARS/R 2.0-7-1*	2.0	32	7	1.00				●
	ARS/R 2.0-9-1*	2.0	36	9	1.00				●
	ARS/R 2.5-5-1*	2.5	28	5	1.25			●	
	ARS/R 2.5-9-1*	2.5	36	9	1.25				●
	ARS/R 3.0-5-1*	3.0	28	5	1.50			●	
	ARS/R 3.0-9-1*	3.0	36	9	1.50				●
	ARS/R 1.0-5-J020	1.0	28	5	0.50			●	
	ARS/R 1.5-5-J020	1.5	28	5	0.75			●	
	ARS/R 1.5-9-J020	1.5	36	9	0.75				●
	ARS/R 2.0-5-J020	2.0	28	5	1.00			●	
	ARS/R 2.0-9-J020	2.0	36	9	1.00		●		●
	ARS/R 2.5-5-J020	2.5	28	5	1.25			●	
	ARS/R 2.5-9-J020	2.5	36	9	1.25				●
	ARS/R 3.0-5-J020	3.0	28	5	1.50			●	
	ARS/R 3.0-9-J020	3.0	36	9	1.50				●
 左向圓鼻刀 Left Direction Round Blade	ARS/L 1.0-5-2*	1.0	28	5	0.50			●	
	ARS/L 1.5-5-2*	1.5	28	5	0.75			●	
	ARS/L 1.5-9-2*	1.5	36	9	0.75				●
	ARS/L 2.0-5-2*	2.0	28	5	1.00			●	
	ARS/L 2.0-9-2*	2.0	36	9	1.00				●
	ARS/L 1.0-5-1*	1.0	28	5	0.50			●	
	ARS/L 1.5-5-1*	1.5	28	5	0.75			●	
	ARS/L 1.5-9-1*	1.5	36	9	0.75				●
	ARS/L 2.0-5-1*	2.0	28	5	1.00			●	
	ARS/L 2.0-9-1*	2.0	36	9	1.00	●			●
	ARS/L 2.5-5-1*	2.5	28	5	1.25			●	
	ARS/L 2.5-9-1*	2.5	36	9	1.25				●
	ARS/L 3.0-5-1*	3.0	28	5	1.50			●	
	ARS/L 3.0-9-1*	3.0	36	9	1.50				●
	ARS/L 1.0-5-J020	1.0	28	5	0.50			●	
	ARS/L 1.5-5-J020	1.5	28	5	0.75			●	
	ARS/L 1.5-9-J020	1.5	36	9	0.75				●
	ARS/L 2.0-5-J020	2.0	28	5	1.00			●	
	ARS/L 2.0-9-J020	2.0	36	9	1.00		●		●
	ARS/L 2.5-5-J020	2.5	28	5	1.25			●	
	ARS/L 2.5-9-J020	2.5	36	9	1.25				●
	ARS/L 3.0-5-J020	3.0	28	5	1.50			●	
ARS/L 3.0-9-J020	3.0	36	9	1.50				●	



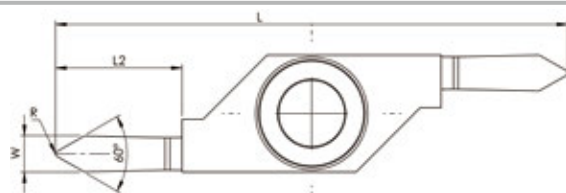

右向圖示(單位:mm)

型號 Item No.	W	L	L2	R	塗層Plating		適用刀架(A/LR 0808~2525)	
					Tin	AiTLxN	132	136
 右向V型牙刀 Right Direction V-Shaped Threading Blade(60°)	AH/R AG60 2.0-5-2*	2.0	34	5				●
	AH/R AG60 2.0-5-2* (R0.2)	2.0	34	5	0.2			●
	AH/R AG60 2.0-5-1*	2.0	34	5				●
	AH/R AG60 2.0-5-1* (R0.2)	2.0	34	5	0.2	●		●
	AH/R AG60 2.0-5-1* (E1)	2.0	34	5				●
	AH/R AG60 2.0-5-1* (E1 R0.2)	2.0	34	5	0.2			●
	AH/R AG60 2.0-5-J020	2.0	34	5	0.1		●	●
	AH/R AG60 2.0-5-J020 (R0.2)	2.0	34	5	0.2			●
 左向V型牙刀 Left Direction V-Shaped Threading Blade(60°)	AH/L AG60 2.0-5-2*	2.0	34	5				●
	AH/L AG60 2.0-5-2* (R0.2)	2.0	34	5	0.2			●
	AH/L AG60 2.0-5-1*	2.0	34	5		●		●
	AH/L AG60 2.0-5-1* (R0.2)	2.0	34	5	0.2			●
	AH/L AG60 2.0-5-J020	2.0	34	5	0.1			●
	AH/L AG60 2.0-5-J020 (R0.2)	2.0	34	5	0.2		●	●



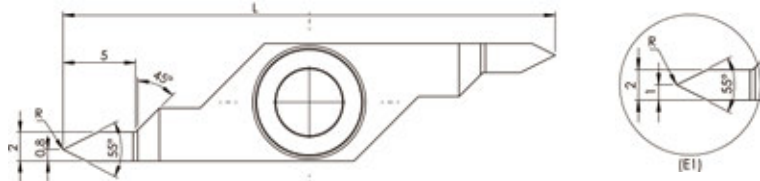

右向圖示(單位:mm)

型號 Item No.	W	L	L2	R	塗層Plating		適用刀架(A/LR 0808~2525)	
					Tin	AiTLxN	132	136
 右向V型牙刀 Right Direction V-Shaped Threading Blade(60°)	AH/R AG60 1.5-5-1*	1.5	32	5				●
	AH/R AG60 1.5-5-1* (R0.1)	1.5	32	5	0.1			●
	AH/R AG60 1.5-7-1*	1.5	32	7				●
	AH/R AG60 1.5-7-1* (R0.1)	1.5	32	7	0.1			●
	AH/R AG60 2.0-7-1*	2.0	36	7				●
	AH/R AG60 2.0-7-1* (R0.1)	2.0	36	7	0.1			●
	AH/R AG60 2.0-9-1*	2.0	36	9		●		●
	AH/R AG60 2.0-9-1* (R0.1)	2.0	36	9	0.1			●
	AH/R AG60 2.5-7-1*	2.5	36	7				●
	AH/R AG60 2.5-7-1* (R0.2)	2.5	36	7	0.2			●
	AH/R AG60 2.5-9-1*	2.5	36	9				●
	AH/R AG60 2.5-9-1* (R0.2)	2.5	36	9	0.2			●
	AH/R AG60 3.0-9-1*	3.0	36	9				●
	AH/R AG60 3.0-9-1* (R0.2)	3.0	36	9	0.2			●
 左向V型牙刀 Left Direction V-Shaped Threading Blade(60°)	AH/L AG60 1.5-5-1*	1.5	32	5				●
	AH/L AG60 2.5-9-1*	2.5	36	9		●		●
	AH/L AG60 2.5-9-1* (R0.2)	2.5	36	9	0.2			●
	AH/L AG60 3.0-9-1*	3.0	36	9				●
	AH/L AG60 2.5-9-J020 (R0.2)	2.5	36	9	0.2			●
	AH/L AG60 3.0-9-J020 (R0.2)	3.0	36	9	0.2		●	●



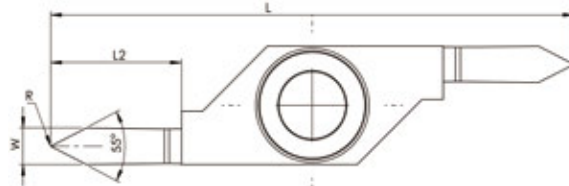

右向圖示(單位:mm)

	型號 Item No.	W	L	L2	R	塗層Plating		適用刀架(A/LR 0808~2525)	
						Tin	AiTLxN	132	136
 右向V型牙刀 (55°) Right Direction V-Shaped Threading Blade(55°)	AH/R AG55 2.0-5-2*	2.0	34	5					●
	AH/R AG55 2.0-5-2* (R0.2)	2.0	34	5	0.2				●
	AH/R AG55 2.0-5-1*	2.0	34	5					●
	AH/R AG55 2.0-5-1* (R0.2)	2.0	34	5	0.2	●			●
	AH/R AG55 2.0-5-1* (E1)	2.0	34	5					●
	AH/R AG55 2.0-5-1* (E1 R0.2)	2.0	34	5	0.2				●
	AH/R AG55 2.0-5-J020	2.0	34	5	0.1		●		●
	AH/R AG55 2.0-5-J020 (R0.2)	2.0	34	5	0.2				●
 左向V型牙刀 (55°) Left Direction V-Shaped Threading Blade(55°)	AH/L AG55 2.0-5-2*	2.0	34	5					●
	AH/L AG55 2.0-5-2* (R0.2)	2.0	34	5	0.2				●
	AH/L AG55 2.0-5-1*	2.0	34	5					●
	AH/L AG55 2.0-5-1* (R0.2)	2.0	34	5	0.2	●			●
	AH/L AG55 2.0-5-J020	2.0	34	5	0.1				●
	AH/L AG55 2.0-5-J020 (R0.2)	2.0	34	5	0.2		●		●



右向圖示(單位:mm)

	型號 Item No.	W	L	L2	R	塗層Plating		適用刀架(A/LR 0808~2525)	
						Tin	AiTLxN	132	136
 右向V型牙刀 (55°) Right Direction V-Shaped Threading Blade(55°)	AH/R AG55 1.5-5-1*	1.5	32	5					●
	AH/R AG55 1.5-5-1* (R0.1)	1.5	32	5	0.1				●
	AH/R AG55 1.5-7-1*	1.5	32	7					●
	AH/R AG55 2.0-9-1*	2.0	36	9					●
	AH/R AG55 2.0-9-1* (R0.1)	2.0	36	9	0.1				●
	AH/R AG55 2.0-9-1* (R0.2)	2.0	36	9	0.2	●			●
	AH/R AG55 2.5-9-1*	2.5	36	9					●
	AH/R AG55 2.5-9-1* (R0.2)	2.5	36	9	0.2				●
	AH/R AG55 2.5-9-J020	2.5	36	9	0.1		●		●
	AH/R AG55 3.0-9-J020 (R0.2)	3.0	36	9	0.2				●
 左向V型牙刀 (55°) Left Direction V-Shaped Threading Blade(55°)	AH/L AG55 1.5-5-1*	1.5	32	5					●
	AH/L AG55 2.5-9-1*	2.5	36	9					●
	AH/L AG55 2.5-9-1* (R0.2)	2.5	36	9	0.2	●			●
	AH/L AG55 3.0-9-1*	3.0	36	9					●
	AH/L AG55 3.0-9-1* (R0.2)	3.0	36	9	0.2				●
	AH/L AG55 2.5-9-J020	2.5	36	9	0.1				●
	AH/L AG55 2.5-9-J020 (R0.2)	2.5	36	9	0.2		●		●
	AH/L AG55 3.0-9-J020	3.0	36	9	0.1				●

端面刀架AE

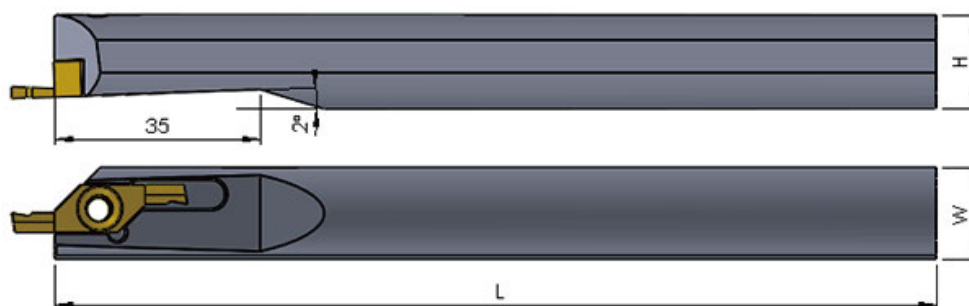

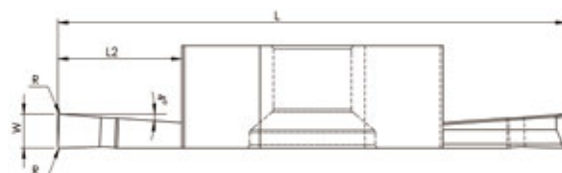

右向圖示(單位:mm)

型號 Item No.		W	H	L	適用刀片 Applicable Inserts
右向刀架 Right Direction Blade Base	AE/R D16-150	15	16	150	右向端面槽刀(AHE/R)
左向刀架 Left Direction Blade Base	AE/L D16-150	15	16	150	左向端面槽刀(AHE/L)



右向端面圖示(單位:mm)

	型號 Item No.	W	L	L2	R	塗層Plating		適用刀架 Applicable Blade Base
						Tin	AiTLxN	
 右向端面槽刀 Right Direction Internal Face Grooving Blade	AHE/R 00-1.5-4-D13-R0.1-1*	1.5	24	4	0.1	●		AE/R D16-150
	AHE/R 00-2.0-4-D13-R0.1-1*	2.0	24	4	0.1			
	AHE/R 00-2.0-7-D13-R0.1-1*	2.0	30	7	0.1			
	AHE/R 00-2.5-4-D13-R0.1-1*	2.5	24	4	0.1			
	AHE/R 00-2.5-7-D13-R0.1-1*	2.5	30	7	0.1			
	AHE/R 00-3.0-4-D13-R0.1-1*	3.0	24	4	0.1			
 左向端面槽刀 Left Direction Internal Face Grooving Blade	AHE/L 00-1.5-4-D13-R0.1-1*	1.5	24	4	0.1	●		AE/L D16-150
	AHE/L 00-2.0-4-D13-R0.1-1*	2.0	24	4	0.1			
	AHE/L 00-2.0-7-D13-R0.1-1*	2.0	30	7	0.1			
	AHE/L 00-2.5-4-D13-R0.1-1*	2.5	24	4	0.1			
	AHE/L 00-2.5-7-D13-R0.1-1*	2.5	30	7	0.1			
	AHE/L 00-3.0-4-D13-R0.1-1*	3.0	24	4	0.1			

側邊刀架

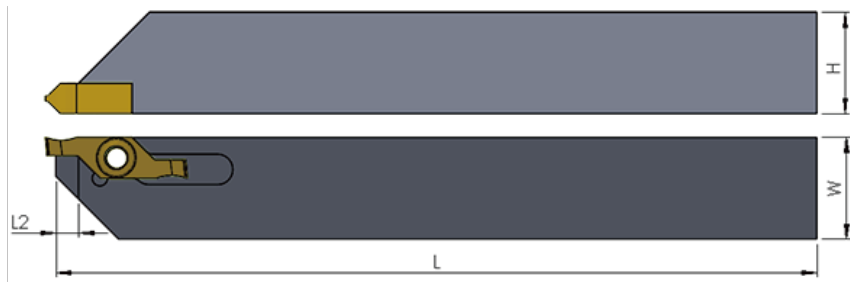

右向側邊圖示(單位:mm)

型號 Item No.		W	H	L	L2	適用刀片 Applicable Inserts
右向刀架 Right Direction Blade Base	側邊刀架R (20*20)	20	20	150	4.5	左向側邊特殊成型刀片
	側邊刀架R (25*25)	25	25	150	6	
左向刀架 Left Direction Blade Base	側邊刀架L (20*20)	20	20	150	4.5	右向側邊特殊成型刀片
	側邊刀架L (25*25)	25	25	150	6	

側固式刀架

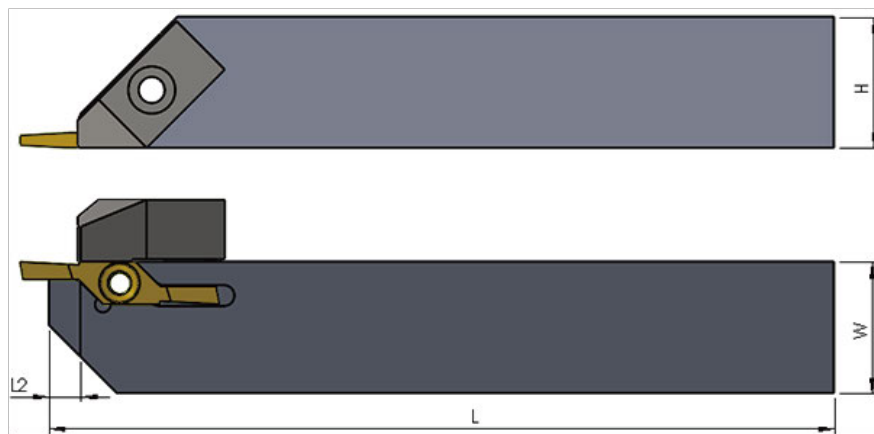

右向側邊圖示(單位:mm)

型號 Item No.		W	H	L	L2	適用刀片 Applicable Inserts
右向刀架 Right Direction Blade Base	側固式刀架R (25*25)	25	25	150	6	左向側邊特殊成型刀片
左向刀架 Left Direction Blade Base	側固式刀架L (25*25)	25	25	150	6	右向側邊特殊成型刀片

特殊成型刀具, 歡迎附圖另行訂購

For special customized blades, please make an order with your design.

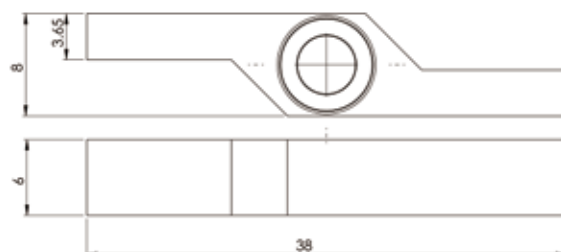

左向側邊圖示(單位:mm)

圖 示

適用刀架
Applicable Blade Base

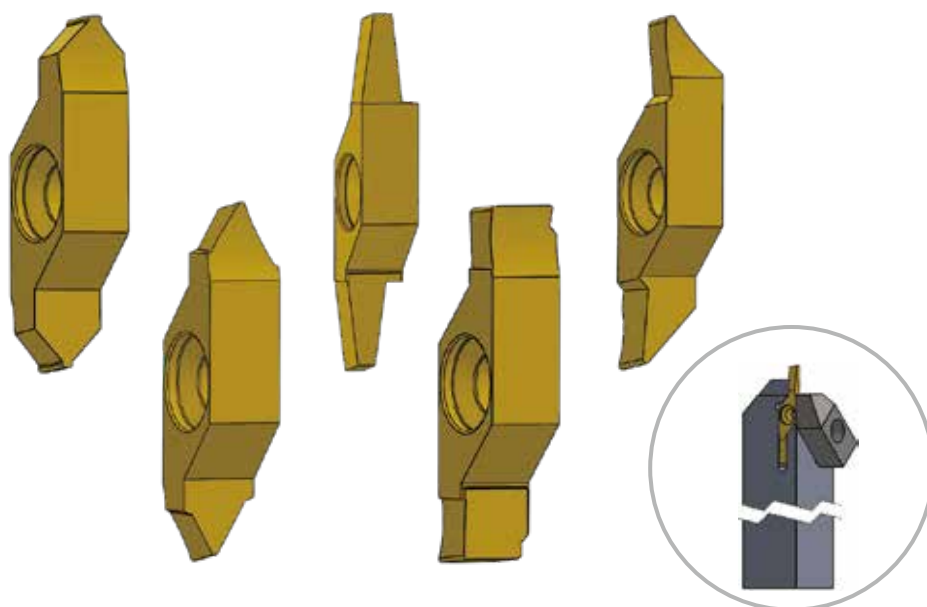

側向刀架
2020~2525系列

